

THE HISTORY OF ARCHITECTURE

FROM PREHISTORIC TO MODERN TIMES



**The fifteenth Album:
THE WESTERN EUROPEAN
AND THE NORTH AMERICAN
NEW TIMES ARCHITECTURE**



Albums of characteristic examples for the Educational course

by Dr. Konstantin I.Samoilov

Almaty, 2017

This series of albums generated for information purposes of the Educational course "The General History of Architecture": 2 credits / 30 hours of lectures.

Until the mid-19th century, examples are grouped by region. In this period, the phenomenon of a single world architectural process begins to manifest itself. Since the last third of the 19th century, examples have been grouped by decades.

Thirty albums illustrate the following topics:

- the 1st Album: EDUCATIONAL AND SCIENTIFIC-THEORETICAL SOURCES
- the 2nd Album: THE PREHISTORIC ERA'S ARCHITECTURE
- the 3rd Album: THE ANCIENT EGYPTIAN ARCHITECTURE
- the 4th Album: THE ANCIENT MESOPOTAMIAN ARCHITECTURE
- the 5th Album: THE ANCIENT GREEK ARCHITECTURE
- the 6th Album: THE ANCIENT ROMAN ARCHITECTURE
- the 7th Album: THE MEDIEVAL EUROPEAN ARCHITECTURE
- the 8th Album: THE EUROPEAN RENAISSANCE'S ARCHITECTURE
- the 9th Album: THE MEDIEVAL MAGHREB'S, THE NEAR EASTERN AND THE CAUCASUS'S ARCHITECTURE
- the 10th Album: THE MEDIEVAL CENTRAL ASIAN ARCHITECTURE
- the 11th Album: THE ANCIENT AND MEDIEVAL CHINESE ARCHITECTURE
- the 12th Album: THE MEDIEVAL SOUTHEASTERN AND EASTERN ASIAN ARCHITECTURE
- the 13th Album: THE MEDIEVAL CENTRAL AMERICAN ARCHITECTURE
- the 14th Album: THE EASTERN EUROPE MIDDLE AGES AND NEW TIMES ARCHITECTURE
- **the 15th Album: THE WESTERN EUROPEAN AND THE NORTH AMERICAN NEW TIMES ARCHITECTURE**

- the 16th Album: THE WORLD'S ARCHITECTURE OF THE 1870's
- the 17th Album: THE WORLD'S ARCHITECTURE OF THE 1880's
- the 18th Album: THE WORLD'S ARCHITECTURE OF THE 1890's
- the 19th Album: THE WORLD'S ARCHITECTURE OF THE 1900's
- the 20th Album: THE WORLD'S ARCHITECTURE OF THE 1910's
- the 21st Album: THE WORLD'S ARCHITECTURE OF THE 1920's
- the 22nd Album: THE WORLD'S ARCHITECTURE OF THE 1930's
- the 23rd Album: THE WORLD'S ARCHITECTURE OF THE 1940's
- the 24th Album: THE WORLD'S ARCHITECTURE OF THE 1950's
- the 25th Album: THE WORLD'S ARCHITECTURE OF THE 1960's
- the 26th Album: THE WORLD'S ARCHITECTURE OF THE 1970's
- the 27th Album: THE WORLD'S ARCHITECTURE OF THE 1980's
- the 28th Album: THE WORLD'S ARCHITECTURE OF THE 1990's
- the 29th Album: THE WORLD'S ARCHITECTURE OF THE 2000's
- the 30th Album: THE WORLD'S ARCHITECTURE OF THE 2010's

Examples are distributed in chronological order of the construct completion.

Images sources are indicated directly near with illustrations on each page.

Architects and companies listed on the basis of aggregate data from different sources (for some objects from various sources indicate different authors). About some buildings listed authors in the available sources has not yet been found.

The Author expresses his gratitude to Internet resources – <https://www.google.com> ; <https://www.wikipedia.org> – which to provide the ability to collect an information.

The 15th Album's front cover:

The Metropolitan Cathedral of the Assumption of the Most Blessed Virgin Mary into Heaven, Mexico city, Mexico, 1573 / 1813

(Arch. Claudio de Arciniega) - [https://upload.wikimedia.org/wikipedia/commons/c/c6/Catedral de M%C3%A9xico.jpg](https://upload.wikimedia.org/wikipedia/commons/c/c6/Catedral_de_M%C3%A9xico.jpg)

The "Zwinger" palace, Dresden, Germany, 1728 / 1855 (Arch. Matthäus Daniel Pöppelmann / Gottfried Semper) –

<http://abload.de/img/zwinger33ccrq6.jpg>

The "Crystal Palace" - Great Exhibition's palace, London, United Kingdom, 1851(Arch. Joseph Paxton) –

[http://images.adsttc.com/media/images/51d4/79f7/b3fc/4b9e/0f00/019b/large_jpg/800px-Crystal Palace - plan.jpg?1372879349](http://images.adsttc.com/media/images/51d4/79f7/b3fc/4b9e/0f00/019b/large_jpg/800px-Crystal_Palace_-_plan.jpg?1372879349)

The United States Capitol, Washington, D.C., USA, 1800 / 1863 (Arch. William Thornton) –

[https://upload.wikimedia.org/wikipedia/commons/thumb/a/a3/United States Capitol west front edit2.jpg/1920px-](https://upload.wikimedia.org/wikipedia/commons/thumb/a/a3/United_States_Capitol_west_front_edit2.jpg/1920px-United_States_Capitol_west_front_edit2.jpg)

[United States Capitol west front edit2.jpg](https://upload.wikimedia.org/wikipedia/commons/thumb/a/a3/United_States_Capitol_west_front_edit2.jpg/1920px-United_States_Capitol_west_front_edit2.jpg)

Purpose of the 15th Lecture:

To study the basic features of the Western European and the North American New Times architecture.

Tasks of the 15th Lecture:

- To consider characteristic examples of specifically organized spaces and buildings;
- To accentuate the features of construction depending on the availability of building materials;
- To emphasize the difference between cult and dwelling buildings.

Tasks for the self-research work:

1. Study the change in the nomenclature of buildings and structures during the evolution of the Mexican, USA's, German, French, British, Spanish New Times Architecture.
2. Analyze geometric parameters of main types of structures and buildings.

Questions for the self-preparation:

1. Accentuate the features of the USA's New Times architecture
2. Accentuate the features of the Mexican New Times architecture

Themes of abstracts (16 pages, 40 000 characters, A4 format):

1. The evolution of the British New Times Architecture
2. The evolution of the French New Times Architecture
3. The evolution of the German New Times Architecture

Examples for the 15th Lecture:

15.1 The Metropolitan Cathedral of the Assumption of the Most Blessed Virgin Mary into Heaven, Mexico city, Mexico, 1573 / 1813 (Arch. Claudio de Arciniega)

15.2 The Palace of Versailles / Château de Versailles, Versailles, Île-de-France, France, 1682 (Arch. Louis Le Vau)

15.3 The "Sanssouci" palace, Potsdam, Germany, 1747 (Arch. Frederick the Great's sketches, Georg Wenzeslaus von Knobelsdorff)

15.4 The "Zwinger" palace, Dresden, Germany, 1728 / 1855 (Arch. Matthäus Daniel Pöppelmann / Gottfried Semper)

15.5 The Museo del Prado, Madrid, Spain, 1819 (Arch. Juan de Villanueva)

15.6 The L'église de la Madeleine / the Madeleine Church, Paris, France, 1823 (Arch. Pierre-Alexandre Vignon, Pierre Contant d'Ivry, Jacques-Marie Huvé, Guillaume-Martin Couture)

15.7 The Royal Pavilion, Brighton, United Kingdom, 1823 (Arch. John Nash, Augustus Charles Pugin, Henry Holland, William Porden)

15.8 The "Crystal Palace" - Great Exhibition's palace, London, United Kingdom, 1851 (Arch. Joseph Paxton)

15.9 The Palace of Westminster / the Houses of Parliament, London, United Kingdom, 1860 (Arch. Charles Barry, Augustus Welby Northmore Pugin)

15.10 The United States Capitol, Washington, D.C., USA, 1800 / 1863 (Arch. William Thornton)

15.1 The Metropolitan Cathedral of the Assumption of the Most Blessed Virgin Mary into Heaven, Mexico city, Mexico, 1573 / 1813 (Arch. Claudio de Arciniega)



Sources: https://upload.wikimedia.org/wikipedia/commons/c/c6/Catedral_de_M%C3%A9xico.jpg; https://doniqanmerritt.files.wordpress.com/2013/05/img_0018.jpg; https://www.ecured.cu/images/c/c8/Claudio_de_Arciniega.jpg

15.2 The Palace of Versailles / Château de Versailles, Versailles, Île-de-France, France, 1682 (Arch. Louis Le Vau)

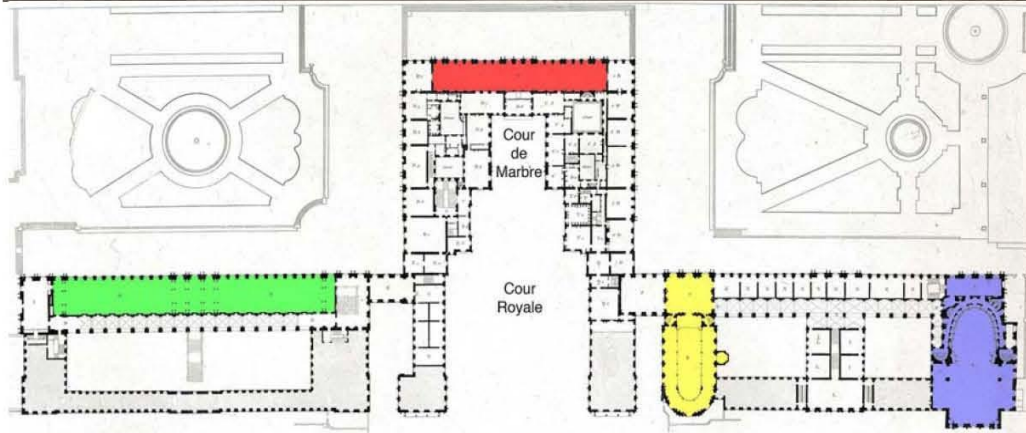

Sources: [https://upload.wikimedia.org/wikipedia/commons/thumb/b/be/Peter Stehlik 2013.04.22 Panorama 1A.jpg/1920px-Peter Stehlik 2013.04.22 Panorama 1A.jpg](https://upload.wikimedia.org/wikipedia/commons/thumb/b/be/Peter_Stehlik_2013.04.22_Panorama_1A.jpg/1920px-Peter_Stehlik_2013.04.22_Panorama_1A.jpg) ;
[https://upload.wikimedia.org/wikipedia/commons/thumb/2/25/Plans du rez-de-chauss%C3%A9e et du premier %C3%A9tage du palais de Versailles%2C %C3%89diteur Gavard%2C premier %C3%A9tage - Gallica 2011 %28detail%2C color-coded%29.jpg/1920px-Plans du rez-de-chauss%C3%A9e et du premier %C3%A9tage du palais de Versailles%2C %C3%89diteur Gavard%2C premier %C3%A9tage - Gallica 2011 %28detail%2C color-coded%29.jpg](https://upload.wikimedia.org/wikipedia/commons/thumb/2/25/Plans_du_rez-de-chauss%C3%A9e_et_du_premier_%C3%A9tage_du_palais_de_Versailles%2C_%C3%89diteur_Gavard%2C_premier_%C3%A9tage_-_Gallica_2011_%28detail%2C_color-coded%29.jpg/1920px-Plans_du_rez-de-chauss%C3%A9e_et_du_premier_%C3%A9tage_du_palais_de_Versailles%2C_%C3%89diteur_Gavard%2C_premier_%C3%A9tage_-_Gallica_2011_%28detail%2C_color-coded%29.jpg) ;
<https://upload.wikimedia.org/wikipedia/commons/thumb/a/a3/Versaillespanoraama2.jpg/1920px-Versaillespanoraama2.jpg> ;
[https://upload.wikimedia.org/wikipedia/commons/thumb/e/e8/Cour de Marbre du Ch%C3%A2teau de Versailles October 5%2C 2011.jpg/1280px-Cour de Marbre du Ch%C3%A2teau de Versailles October 5%2C 2011.jpg](https://upload.wikimedia.org/wikipedia/commons/thumb/e/e8/Cour_de_Marbre_du_Ch%C3%A2teau_de_Versailles_October_5%2C_2011.jpg/1280px-Cour_de_Marbre_du_Ch%C3%A2teau_de_Versailles_October_5%2C_2011.jpg) ;
[https://upload.wikimedia.org/wikipedia/commons/thumb/b/bc/Louis Le Vau.jpg/800px-Louis Le Vau.jpg](https://upload.wikimedia.org/wikipedia/commons/thumb/b/bc/Louis_Le_Vau.jpg/800px-Louis_Le_Vau.jpg)

15.3 The "Sanssouci" palace, Potsdam, Germany, 1747 (Arch. Frederick the Great's sketches, Georg Wenzeslaus von Knobelsdorff)



Sources: <https://upload.wikimedia.org/wikipedia/commons/1/1c/Sanssouci-Air.JPG> ; http://img09.deviantart.net/97b0/i/2011/093/8/8/the_new_chambers_in_sanssouci_by_pingallery-d3d3lql.jpg ;
http://img11.deviantart.net/664f/i/2012/329/1/1/park_sanssouci_chinese_house_by_pingallery-d5m4g0x.jpg ;
<https://cdn.getyourguide.com/niwziy2l9cvz/2lucq84V9Vvma2yqoSkWaCs/965deb538b5c403c02b085f8127a834e/sanssouci-potsdam-1500x850.jpg> ;
<https://cdn.getyourguide.com/niwziy2l9cvz/4lqpyu16HemYqMOiwAeow4/e4c689acfa7880b1889aa052332397d0/sanssouci-potsdam-1500x850.jpg> ;
https://upload.wikimedia.org/wikipedia/commons/9/90/Friedrich_Zweite_Alt.jpg ; https://upload.wikimedia.org/wikipedia/commons/8/8a/Georg_Wenzeslaus_von_Knobelsdorff_1738.jpg

15.4 The "Zwinger" palace, Dresden, Germany, 1728 / 1855 (Arch. Matthäus Daniel Pöppelmann / Gottfried Semper)

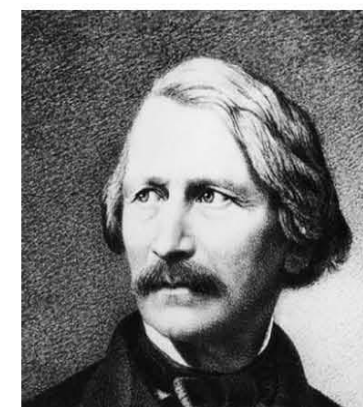

Sources: http://drazdany.poznej.com/files/zwinger_4.jpg ; <http://www.dresden-online.de/files/dresden-online/rubriken/kultur/sehenswuerdigkeiten/zwinger-dresden-bildpixel-pixelio.jpg> ;
<http://abload.de/img/zwinger33ccra6.jpg> ; [http://www.goruma.de/export/sites/www.goruma.de/Globale_Inhalte/Bilder/Content/D/Deutschland Dresden Zwinger 1 1200.jpg](http://www.goruma.de/export/sites/www.goruma.de/Globale_Inhalte/Bilder/Content/D/Deutschland_Dresden_Zwinger_1_1200.jpg) ;
http://www.herford.de/media/custom/2044_1125_1_q.JPG?1422031826 ; <https://upload.wikimedia.org/wikipedia/commons/7/7a/Gottfried-semper.jpg>

15.5 The Museo del Prado, Madrid, Spain, 1819 (Arch. Juan de Villanueva)

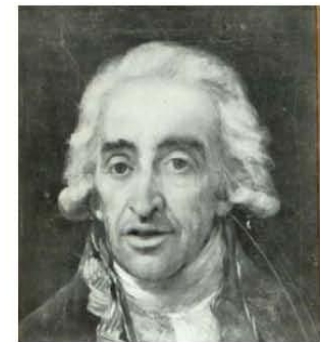

Sources: <http://www.intk.com/nl/organisaties/museo-nacional-del-prado/slideshow/01-DT%20PRADO%2015646620%20web.jpg>; http://artista.s3.amazonaws.com/repository/0/4/0/8156_cuerpo1.jpg; <http://cloud2.todocoleccion.net/libros-segunda-mano-arquitectura/tc/2014/09/11/11/45180262.jpg>

15.6 The L'église de la Madeleine / the Madeleine Church, Paris, France, 1823 (Arch. Pierre-Alexandre Vignon, Pierre Contant d'Ivry, Jacques-Marie Huvé, Guillaume-Martin Couture)

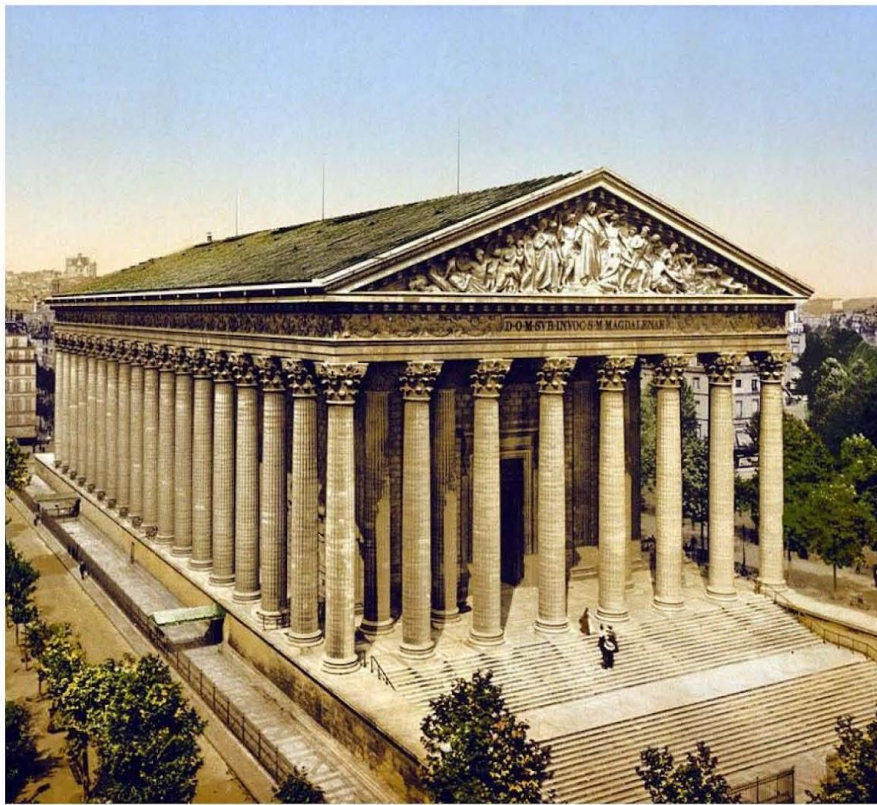

Sources: https://upload.wikimedia.org/wikipedia/commons/thumb/e/e4/The_Madeleine%2C_Paris%2C_France%2C_ca._1890-1900.jpg/1024px-The_Madeleine%2C_Paris%2C_France%2C_ca._1890-1900.jpg ; https://upload.wikimedia.org/wikipedia/commons/a/a7/Vignon,_Alexandre_Pierre.jpg ; https://upload.wikimedia.org/wikipedia/commons/thumb/c/c0/P1030420_Paris_VIII_%C3%A9glise_de_la_Madeleine_colonnes_fa%C3%A7ade_occidentale_rwk.JPG/800px-P1030420_Paris_VIII_%C3%A9glise_de_la_Madeleine_colonnes_fa%C3%A7ade_occidentale_rwk.JPG ; <http://www.savoirs.essonne.fr/typo3temp/pics/7bedab0cea.jpg>

15.7 The Royal Pavilion, Brighton, United Kingdom, 1823 (Arch. John Nash, Augustus Charles Pugin, Henry Holland, William Porden)



Sources: <https://i.ytimg.com/vi/m3rWp4Dwhv0/maxresdefault.jpg> ; <http://www.oliverburns.com/wp-content/uploads/2016/09/Image-via-Fine-Art-America.jpg> ; http://keyassets.timeincuk.net/inspirewp/live/wp-content/uploads/sites/8/2009/08/john_nash2.jpg ; https://upload.wikimedia.org/wikipedia/commons/c/cb/Augustus_Charles_Pugin.jpg ; https://upload.wikimedia.org/wikipedia/commons/thumb/4/47/Henry_Holland_%28architect%29.jpg/320px-Henry_Holland_%28architect%29.jpg

15.8 The "Crystal Palace" - Great Exhibition's palace, London, United Kingdom, 1851 (Arch. Joseph Paxton)

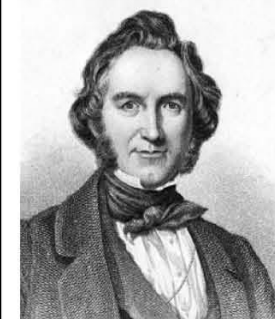
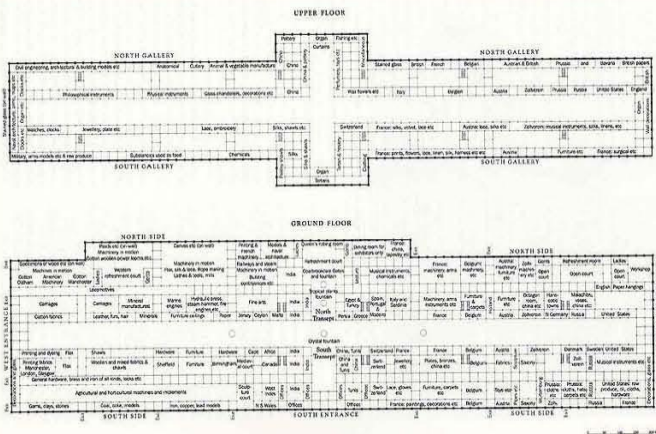
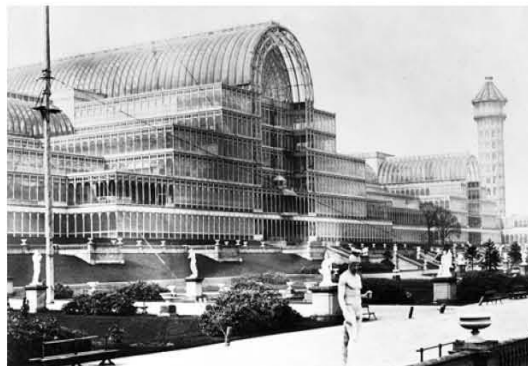

Sources: http://www.lemog.fr/lemog_expo_v2/albums/documentation/autres_expo/pays_divers/cpa_crystal_palace_0574_800.jpg ; <https://rentomod.files.wordpress.com/2013/04/paxton-crystalpalace.jpg> ; http://images.adsttc.com/media/images/51d4/79f7/b3fc/4b9e/0f00/019b/large.jpg/800px-Crystal_Palace_-_plan.jpg?1372879349 ; <https://media1.britannica.com/eb-media/52/12552-004-4BDAFDC8.jpg> ; https://upload.wikimedia.org/wikipedia/commons/e/eb/Crystal_Palace_interior.jpg ; http://biber.co/assets/WORDS/ESSAYS/What-is-an-Expo/1230xAUTO_crop_center-center_85/1409128a01d49dd68038371cda49e92e.jpg ; <http://images.fineartamerica.com/images-medium-large/sir-joseph-paxton-granger.jpg>

15.9 The Palace of Westminster / the Houses of Parliament, London, United Kingdom, 1860 (Arch. Charles Barry, Augustus Welby Northmore Pugin)

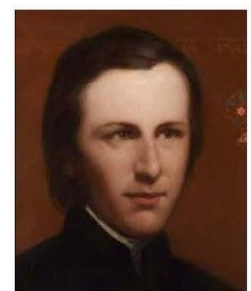
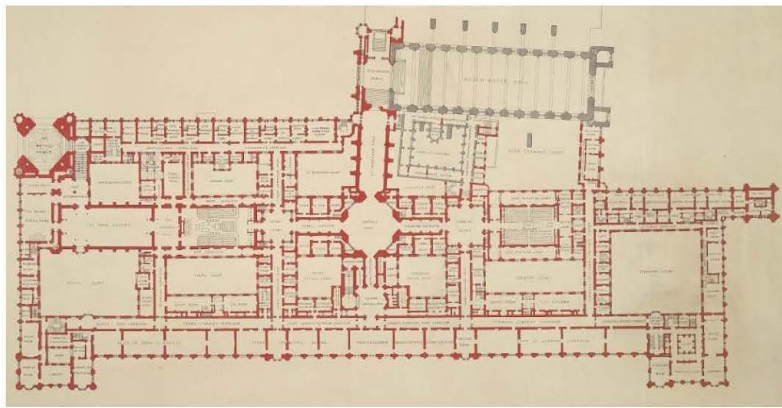

Sources: https://upload.wikimedia.org/wikipedia/commons/thumb/4/42/London_Parliament_2007-1.jpg/1920px-London_Parliament_2007-1.jpg ;
https://upload.wikimedia.org/wikipedia/commons/f/f5/Palace_of_Westminster_plan%2C_F._Crace%2C_high_resolution.png ;
https://upload.wikimedia.org/wikipedia/commons/thumb/3/3e/Victoria_Tower_from_Old_Palace_Yard.jpg/800px-Victoria_Tower_from_Old_Palace_Yard.jpg ;
https://upload.wikimedia.org/wikipedia/commons/d/d0/Sir_Charles_Barry_by_John_Prescott_Knight.jpg ;
https://upload.wikimedia.org/wikipedia/commons/thumb/8/82/Central_Tower%2C_Palace_of_Westminster.jpg/800px-Central_Tower%2C_Palace_of_Westminster.jpg ;
https://upload.wikimedia.org/wikipedia/commons/9/9f/Augustus_Welby_Northmore_Pugin_from_NPG.jpg

15.10 The United States Capitol, Washington, D.C., USA, 1800 / 1863 (Arch. William Thornton)

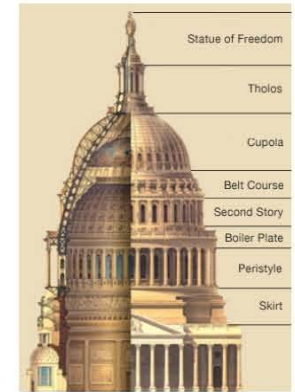
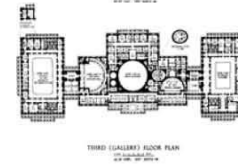
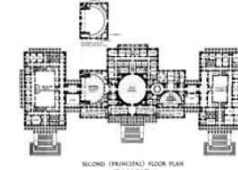
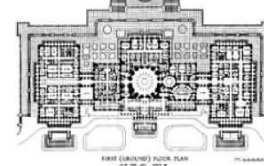
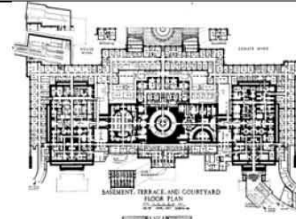

Sources: <https://upload.wikimedia.org/wikipedia/commons/1/1f/Aerial view of the Capitol Hill.jpg> ;
<https://upload.wikimedia.org/wikipedia/commons/thumb/a/a3/United States Capitol west front edit2.jpg/1920px-United States Capitol west front edit2.jpg> ;
<https://upload.wikimedia.org/wikipedia/commons/thumb/8/8c/US Capitol basement floor plan 1997 105th-congress.gif/1280px-US Capitol basement floor plan 1997 105th-congress.gif> ;
<https://upload.wikimedia.org/wikipedia/commons/thumb/9/99/US Capitol first floor plan 1997 105th-congress.gif/1280px-US Capitol first floor plan 1997 105th-congress.g> ;
<https://upload.wikimedia.org/wikipedia/commons/thumb/4/4f/US Capitol second floor plan 1997 105th-congress.gif/1280px-US Capitol second floor plan 1997 105th-congress.gif> ;
<https://upload.wikimedia.org/wikipedia/commons/thumb/6/6c/US Capitol third floor plan 1997 105th-congress.gif/1280px-US Capitol third floor plan 1997 105th-congress.gif> ;
<https://www.aoc.gov/sites/default/files/capitol-dome-diagram.jpg> ; <https://3f009b6523c0c1f8b94-091582592a5f780b4bac3b68414d35fd.ssl.cf5.rackcdn.com/default/destruction-united-states-capitol-01.jpg>

Recommended educational and scientific-theoretical sources:

1. Augustus Pugin / From Wikipedia, the free encyclopedia. - URL: https://en.wikipedia.org/wiki/Augustus_Pugin
2. Charles Barry / From Wikipedia, the free encyclopedia. - URL: https://en.wikipedia.org/wiki/Charles_Barry
3. Palace of Westminster / From Wikipedia, the free encyclopedia. - URL: https://en.wikipedia.org/wiki/Palace_of_Westminster
4. United States Capitol / From Wikipedia, the free encyclopedia. - URL: https://en.wikipedia.org/wiki/United_States_Capitol
5. William Thornton / From Wikipedia, the free encyclopedia - URL: https://en.wikipedia.org/wiki/William_Thornton
6. Architect of the Capitol / From Wikipedia, the free encyclopedia. - URL: https://en.wikipedia.org/wiki/Architect_of_the_Capitol
7. Palace of Versailles / From Wikipedia, the free encyclopedia. - URL: https://en.wikipedia.org/wiki/Palace_of_Versailles
8. Louis Le Vau / From Wikipedia, the free encyclopedia. - URL: https://en.wikipedia.org/wiki/Louis_Le_Vau
9. Sanssouci / From Wikipedia, the free encyclopedia. - URL: <https://en.wikipedia.org/wiki/Sanssouci>
10. Georg Wenzeslaus von Knobelsdorff / From Wikipedia, the free encyclopedia. - URL: https://en.wikipedia.org/wiki/Georg_Wenzeslaus_von_Knobelsdorff
11. Zwinger (Dresden) / From Wikipedia, the free encyclopedia. - URL: [https://en.wikipedia.org/wiki/Zwinger_\(Dresden\)](https://en.wikipedia.org/wiki/Zwinger_(Dresden))
12. Matthäus Daniel Pöppelmann / From Wikipedia, the free encyclopedia. - URL: https://en.wikipedia.org/wiki/Matth%C3%A4us_Daniel_P%C3%B6ppelmann
13. Gottfried Semper / From Wikipedia, the free encyclopedia. - URL: https://en.wikipedia.org/wiki/Gottfried_Semper
14. The Crystal Palace / From Wikipedia, the free encyclopedia. -URL: https://en.wikipedia.org/wiki/The_Crystal_Palace
15. Joseph Paxton / From Wikipedia, the free encyclopedia. - URL: https://en.wikipedia.org/wiki/Joseph_Paxton
16. Royal Pavilion / From Wikipedia, the free encyclopedia. - URL: https://en.wikipedia.org/wiki/Royal_Pavilion

17. John Nash (architect) / From Wikipedia, the free encyclopedia. - URL:
[https://en.wikipedia.org/wiki/John_Nash_\(architect\)](https://en.wikipedia.org/wiki/John_Nash_(architect))
18. Augustus Charles Pugin / From Wikipedia, the free encyclopedia. - URL:
https://en.wikipedia.org/wiki/Augustus_Charles_Pugin
19. Henry Holland (architect) / From Wikipedia, the free encyclopedia. - URL:
[https://en.wikipedia.org/wiki/Henry_Holland_\(architect\)](https://en.wikipedia.org/wiki/Henry_Holland_(architect))
20. William Porden / From Wikipedia, the free encyclopedia. - URL: https://en.wikipedia.org/wiki/William_Porden
21. Museodel Prado / From Wikipedia, the free encyclopedia. - URL: https://en.wikipedia.org/wiki/Museo_del_Prado
22. Juan de Villanueva / From Wikipedia, the free encyclopedia. - URL:
https://en.wikipedia.org/wiki/Juan_de_Villanueva
23. Mexico City Metropolitan Cathedral / From Wikipedia, the free encyclopedia. - URL:
https://en.wikipedia.org/wiki/Mexico_City_Metropolitan_Cathedral
24. La Madeleine, Paris / From Wikipedia, the free encyclopedia. - URL:
https://en.wikipedia.org/wiki/La_Madeleine,_Paris

Briefly about the Author



Konstantin I.SAMOILOV

High Doctorate (Arch) – 2008,
Doctor of Sciences (Arch) – 2004,
Candidate of Sciences / eq. PhD(Arch) – 1990,
Dipl.Arch. / eq. MArch – 1983,
Dipl.Tech.Arch. / eq. BArch – 1977



Associate Professor of the Architectural Faculty –
Kazakh Leading Academy of Architecture and Civil Engineering –
www.kazgasa.kz

E: samconiv@yahoo.com , samconiv@mail.ru

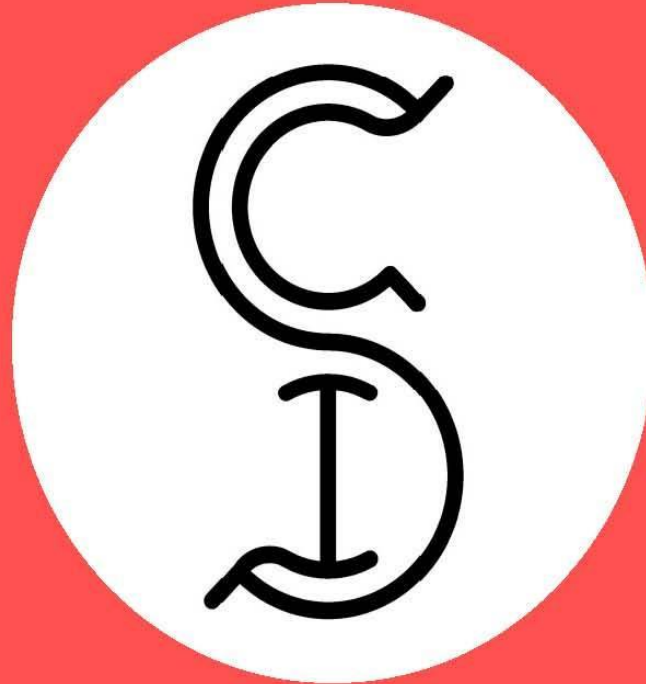

THE HISTORY OF ARCHITECTURE FROM PREHISTORIC TO MODERN TIMES:
Albums of characteristic examples for the Educational course / by Dr. Konstantin I.Samoilov. –
The fifteenth Album: THE WESTERN EUROPEAN AND THE NORTH AMERICAN NEW TIMES
ARCHITECTURE. – Almaty, 2017. – 19 p.