

Please kindly tell us the information as below shown:

1. Clamping slot?
2. Tie bar Distance ?

DESCRIPTION	UNIT	K288F	K358F
1 Clamping force	KN	2880	3580
Opening stroke	mm	370	510
Platen size	mm × mm	835 × 960	950 × 1060
2 Space between tie bars	mm × mm	580 × 580	660 × 660

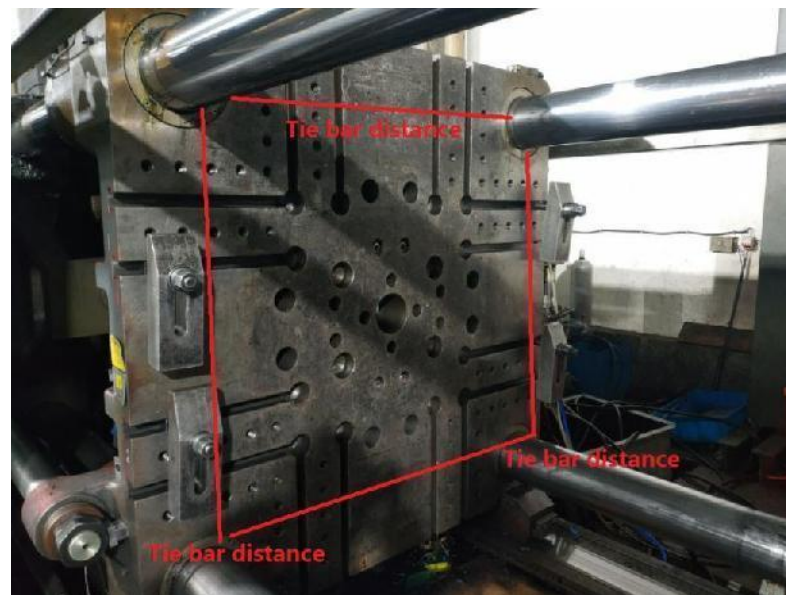

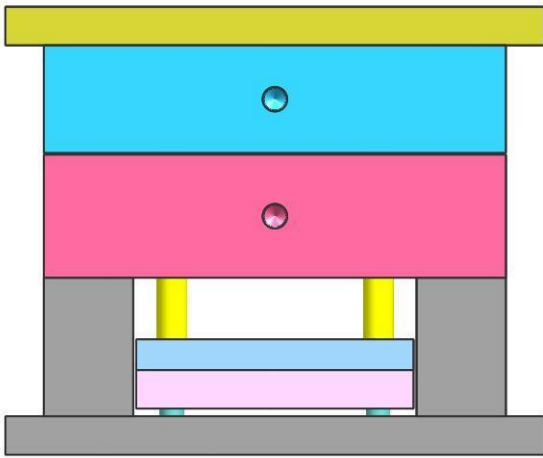

Please kindly tell us the information as below shown:

- 1.The **Min** mould thickness on machine ?
- 2.THE **Max** mould thickness on machine?

		HC-300		
说明	DESCRIPTION	A	B	C
注射装置	INJECTION UNIT			
拉杆内间距	Distance between tie-b	615x615		
最大模厚	Max.mold height	630		
最小模厚	Min.mold height	200		

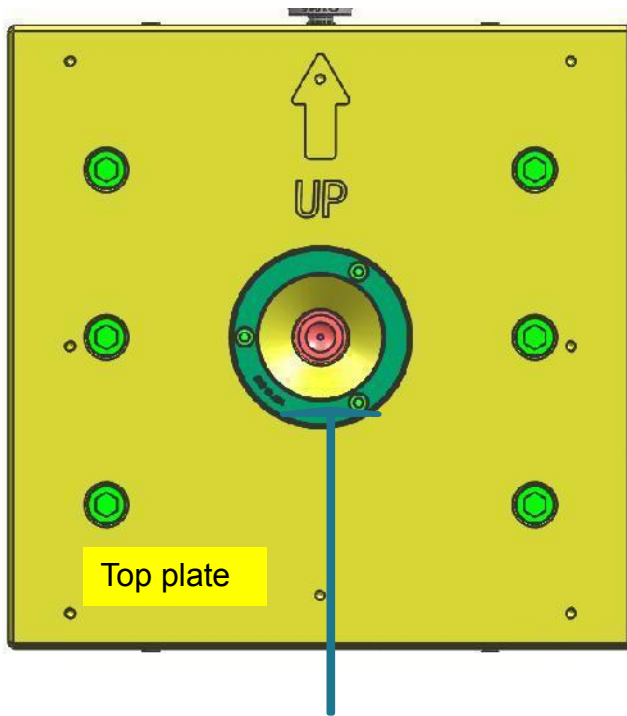

1. What is the locating ring size would you want ?

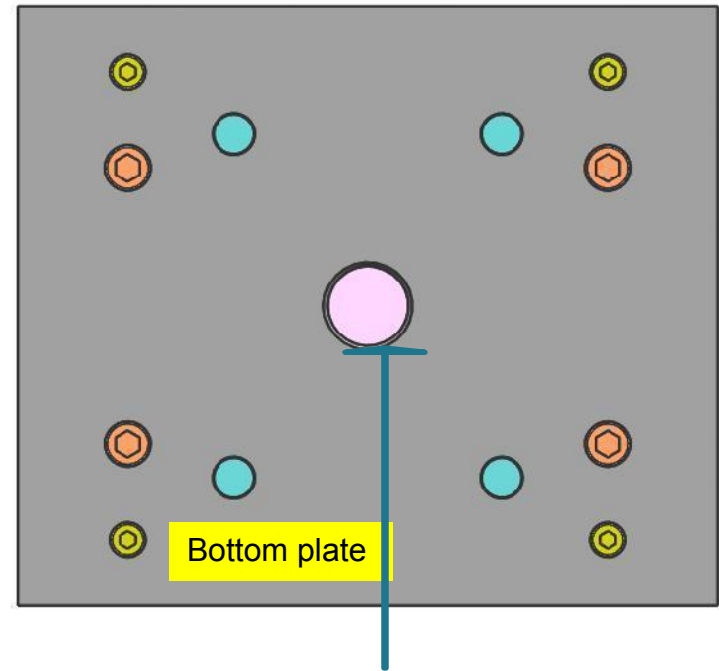

2. The diameter of Ejector hole?

Picture one



Picture two



Picture three

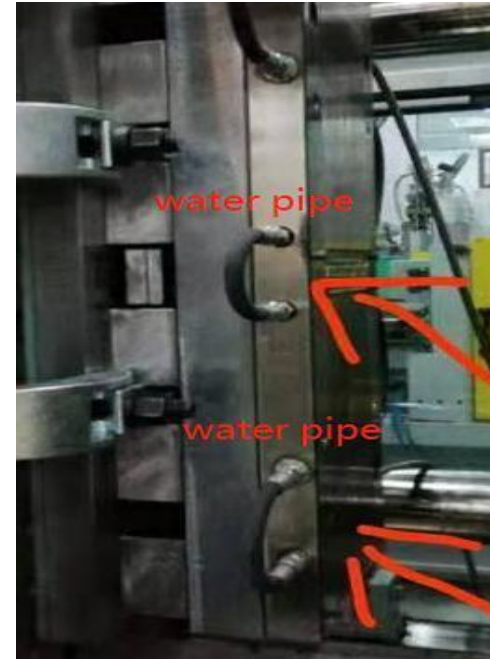

1. What's the type for water cooling fitting ? Metric or Imperial?
2. size : M8 or M10 or M12? Or 1/8, 1/4, 3/8, 1/2, 3/4 ?
3. Could you take a picture to us for your water cooling fitting ? (as picture one and two shown )  
(as picture three shown )

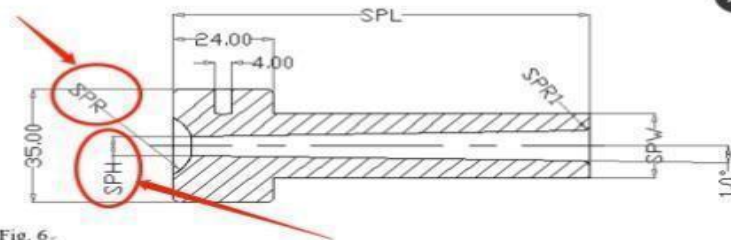
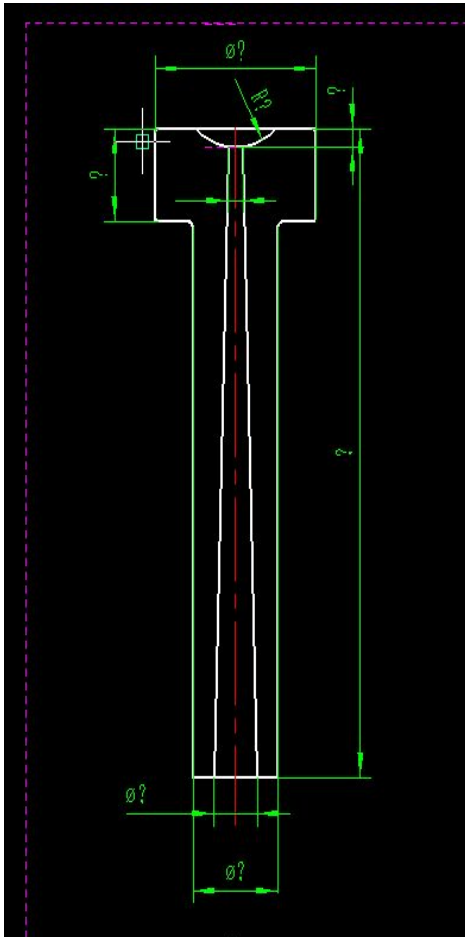

Fig. 6-

Component weight 零件重量	SPL	SPR	SPR1	SPH	SPW
<100grs	60 to 140	10.5	1	3.5	18
100grs to 200 grs	60 to 140	10.5	2	4	18
200grs to 350 grs	60 to 140	10.5	3	6	20
350grs to 450 grs	60 to 140	10.5	3	8	20



SPR Radius ,and the diameter for SPH?



# ZheJiang HuangYan Younger Mould Factory

---

1. Please kindly tell us the **shrinkage** for your material ?