



LMST – Device Connect Images by Model



Qualcomm/MTK full Fastboot Mode



Qualcomm/MTK Fastboot Mode

RSD Server Image File Name: Fastboot_Connect_EN_v1.png
<https://drive.google.com/drive/folders/1h72prfGMEfVvWWHT88IBHD5g12TAF9g>

Supported Use Cases	Models
ALL	Qcomm: All MTK Fastboot: XT2133 (Lisbon) XT2139 (Kyoto) XT2149 (Saipan) XT2165 (Tonga) XT2167 (Corfu) XT2173 (CorfuLite) XT2205 (Dubai) XT2163 (Ellis) XT2205 (Dubai+) XT2211 (Milan) XT2213 (Austin)

Fastboot mode process



- step 1** - Power off your device
- step 2** - Connect the usb cable to the pc
- step 3** - Press and hold the volume down key on your device and connect to the usb cable
- step 4** - Release the volume down key on your device once the green Android image is seen on the phone display



MTK/SC Models



MTK/SC Powered on with usb debugging enabled and CQA Apk keypad sequence

RSD Server Image File Name: MTK_SC_PoweredOn_CQA_Keypad_EN_V1.gif

<https://drive.google.com/drive/folders/1h72prfGMEfVbWWHT881BHD5g12TAF9g>

Supported Use Cases	Internal Name	Models
CIT	Poker plus	XT2025
Batterylink	Bali	XT2029
Read	Hydra	XT2097-1X
Reflash	Malta lite	XT2097-X
Upgrade	Hawaii +	XT2231
WalkinCIT	Hawaii + lite	XT2229
ChannelID	Cyprus	XT2159
SameSN	Aruba	XT2155
NewSN	Fiji/Fiji SC	XT2053
MTKBoard programming	Blackjack	XT2055
B2F	Java	XT2128
	Malta20	XT2095
	Hawaii22	XT2227
	Moba	L79031
	Doom	L70081

MTK/SC Powered on with usb debugging enabled and CQA Apk keypad sequence



- step 1 -** Power on device
- step 2 -** Go to Settings - System - About phone
- step 3 -** Tap on the "Build number" menu option 7 times until the UI shows "You are now a developer"
- step 4 -** Go back to System - Developer options
- step 5 -** Open USB debugging from Debugging menu
- step 6 -** Go back to device home page and open dial pad
- step 7 -** Enter `##2486##` to start CQA test
- step 8 -** Allow all the prompted CQATest permissions on the device UI
- step 9 -** Connect the device to pc using the usb cable



MTK Power On with USB Debugging Enabled

RSD Server Image File Name: MTK_Powered_On_With_USB_Debugging_Enabled_EN_V1.gif

<https://drive.google.com/drive/folders/1h72prfGMEfVvWWHT88IBHD5g12TAF9g>

Supported Use Cases	Internal Name	Models
Reflash CIT New SN Same SN Channel ID	Lacrosse	XT1721

MTK Powered on with usb debugging enabled



- step 1 -** Power on device
- step 2 -** Go to Settings - System - About phone
- step 3 -** Tap on the "Build number" menu option 7 times until the UI shows "You are now a developer"
- step 4 -** Go back to System - Developer options
- step 5 -** Open USB debugging from Debugging menu
- step 6 -** Connect the device to pc using the usb cable
- step 7 -** Accept the CQA prompts on the device UI



MTK – Malta20 and MaltaLite Fastboot Mode for kill switch only

RSD Server Image File Name: Malta20_MaltaLite_MTK_Fastboot_Mode_EN_V1.png

<https://drive.google.com/drive/folders/1h72prfGMEfBvWWHT88IBHD5g12TAF9g>

Supported Use Cases	Internal Name	Models
Kill Switch	Malta20 Malta Lite	XT2095 XT2097-X

MTK enter fastboot mode

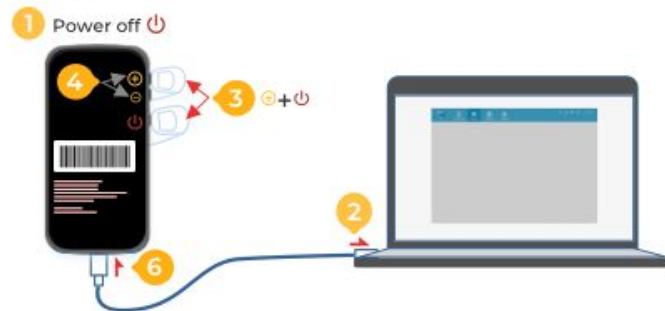

- step 1 -** Power off your device
- step 2 -** Connect the usb cable to the pc
- step 3 -** Press and hold the power button and vol + button at the same time until "Select Boot Mode" list is seen on the device.
- step 4 -** Select fastboot mode with vol+, press vol- to enter fastboot mode.
- step 5 -** After selecting Fastboot Mode, you should see the barcode on the device screen.
- step 6 -** Connect USB cable to the fastboot mode device.



Cyprus / Aruba Fastboot Mode

RSD Server Image File Name: SC_Fastboot_Mode_EN_V1.png

<https://drive.google.com/drive/folders/1h72prfGMEfFvWWHT88IBHD5g12TAF9g>

Supported Use Cases	Internal Name	Models
Kill Switch	Aruba Cyprus	XT2155 XT2159

SC enter fastboot mode



- step 1 -** Power off your device
- step 2 -** Connect the usb cable to the pc
- step 3 -** Press and hold the power button and vol + button at the same time until the "fastboot mode" is seen on the screen.
- step 4 -** Connect USB cable to the fastboot mode device.



Fiji Fastboot Mode

RSD Server Image File Name: Fiji_enter_fastboot_mode_EN_V1.png

<https://drive.google.com/drive/folders/1h72prfGMEfFbvWWHT88IBHD5g12TAF9g>

Supported Use Cases	Internal Name	Models
Kill Switch	Hydra Fiji SC	XT2097-1X XT2053-5/6

SC enter fastboot mode



step 1 - Power off your device

step 2 - Connect the usb cable to the pc

step 3 - Press and hold the power button and the Vol+ button at the same time until the barcode and blue Moto icon is seen on the device screen

step 4 - Connect USB cable to the fastboot mode device.



Hawaii22 Fastboot Mode

RSD Server Image File Name: Hawaii22-enter_fastboot_mode_EN_V1.png

<https://drive.google.com/drive/folders/1h72prfGMEfFbvWWHT88IBHD5g12TAF9g>

Supported Use Cases	Internal Name	Models
Kill Switch	Hawaii22	XT2227

SC enter fastboot mode



- step 1 -** Power off your device
- step 2 -** Connect the usb cable to the pc
- step 3 -** Press and hold the power button and vol + button at the same time until the "fastboot mode" is seen on the screen.
- step 4 -** Connect USB cable to the fastboot mode device.



Moba and Doom – MTK 9008 Fastboot Mode

Moda_and_Doom_9008_Fastboot_mode_EN_V1.png

<https://drive.google.com/drive/folders/1h72prfGMEfFbvWWHT88IBHD5g12TAF9g>

Supported Use Cases	Internal Name	Models
Force Flash	Moba Doom	L79031 L70081

Lenovo product enter 9008 mode



- step 1 -** Power off your device
- step 2 -** Connect the usb cable to the pc
- step 3 -** Press and hold all 3 buttons: The power button plus both the Vol+ and Vol- buttons at the same time
- step 4 -** Hold the buttons for several seconds until the device enters the 9008 mode
- step 5 -** Connect the USB cable to the device. Please use the type-C part of the left side of device



MTK Powered Off Meta Mode

MTK_Power_Off_Meta_Mode_EN_V3.png

<https://drive.google.com/drive/folders/1h72prfGEMfFbvWWHT88IBHD5g12TAF9g>

Supported Use Cases	Internal Name	Models
Force Flash Force Flash	Malta20 Malta Lite	XT2095 XT2097-X
Force Flash & Kill Switch	Bali Poker Plus Fiji Blackjack Hawaii+ Hawaii+Lite	XT2029 XT2025 XT2053 XT2055 XT2231 XT2229

Power off Mode Instructions

1 Power off 

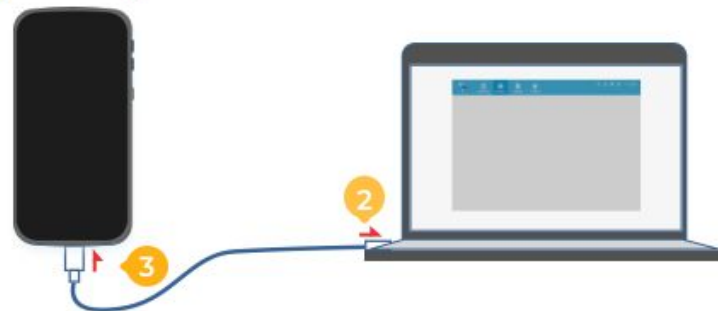

The Recipe will prompt you on when to connect the device using the following process:

step 1 - Power off your device

step 2 - Connect the usb cable to the pc

step 3 - Connect the usb cable to the powered off device



SC Powered Off Mode

SC_Power_Off_Mode_EN_V1.png

<https://drive.google.com/drive/folders/1h72prfGEMfBvWWHT88IBHD5g12TAF9g>

Supported Use Cases	Internal Name	Models
Force Flash	Fiji SC Aruba Cyprus Hawaii22 Hydra	XT2053-5/6 XT2155 XT2159 XT2227 XT2097-1X
Force Flash/Kill switch	Java	XT2128

Power off Mode Instructions

1 Power off 

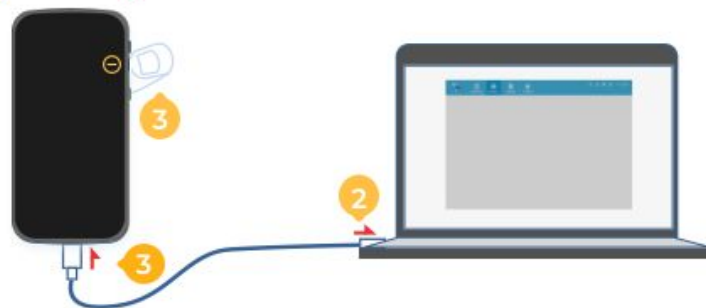

The Recipe will prompt you on when to connect the device using the following process:

step 1 - Power off your device

step 2 - Connect the usb cable to the pc

step 3 - Press and hold the volume down key on your device and connect to the usb cable



Tablets



MTK Tablet Reflash with USB Debugging Enabled

MTK_Tablet_Reflash_with_USB_debugging_enabled_EN_V1.gif

<https://drive.google.com/drive/folders/1ezTCHJ2EjNZaPXxdm09jaBJDEoZcv3mV>

MTK Tablet Reflash with USB debugging enabled

Supported Use Cases	Internal Name	Models
Reflash New SN PCB Provisioning	P11	TB-J616X TB-J616F G70 G70_LTE



- step 1 -** Power on device
- step 2 -** Go to Settings - (System) - About tablet
- step 3 -** Tap on the "Build number" menu option 7 times until the UI shows "You are now a developer"
- step 4 -** Go back to System - Developer options
- step 5 -** Open USB debugging from Debugging menu
- step 6 -** Connect the device to pc using the usb cable
- step 7 -** Accept the auth prompt on the device



MTK Tablet Force Flash

MTK_Tablet_Power_Off_Mode_EN_V1.png

<https://drive.google.com/drive/folders/1ezTCHJ2EjNZaPXXdm09jaBJDEoZcv3mV>

MTK Tablet Force Flash with power off mode

Supported Use Cases	Internal Name	Models
Force Flash Kill Switch	P11	TB-J616X TB-J616F G70 G70_LTE

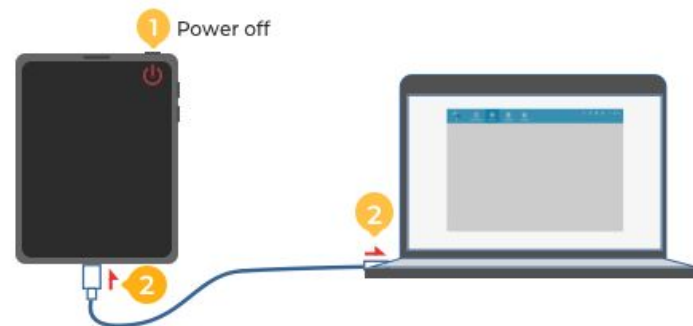

step 1 - Power off your device

step 2 - Connect the device to pc using the usb cable



MTK Tablet Force Flash

QCOM_Tablet_Power_off_mode_EN_V1.png

<https://drive.google.com/drive/folders/1ezTCHJ2EjNZaPXxdm09jaBJDEoZcv3mV>

Supported Use Cases	Internal Name	Models
Force Flash Kill Switch	TB-8704V	TB-8704V

QCOM Tablet Force Flash/Reflash with power off mode

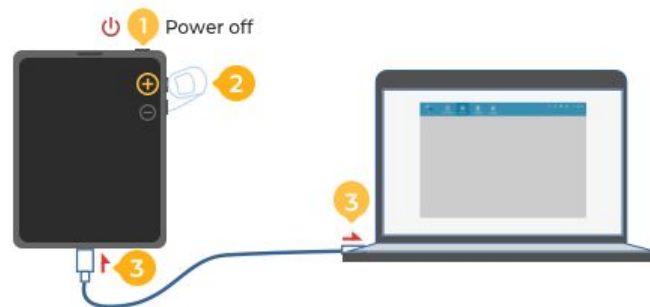

step 1 - Power off your device

step 2 - Press Vol +

step 3 - Connect the device to pc using the usb cable

